

### Introduction

**DRAGON** Cladding System is a range of internal and external cladding designed for purpose used to meet unique project requirements. Special dimension and feature can be ordered according to the enquiry of Designers, Architects and Consultants. The use of materials is generally aluminum or galvanized steel.

### 產品介紹

**天龍牌** 外牆板系統被廣泛應用於室外及室內的外牆設計，目的是為了迎合各式各樣的工程需求。不同尺寸及外觀的外牆板，可按照設計師、工程師及專業顧問的需求而訂製。選用材料則普遍為鋁合金或鍍鋅鐵。

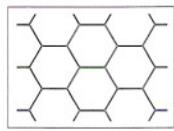

Honey comb  
蜂窩板

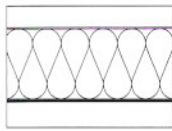

Rock Wool  
玻璃棉



### Infill Materials

They are available with or without infill material like Rock Wool or Honey comb. Rock Wool can achieve fire resistance and excellent sound absorption. Honey comb can promote the flatness and stiffness of the panel.

### 填入材料

外牆板可填入或不填入不同的物料如玻璃棉或蜂窩板材。玻璃棉有防火及隔音的作用，而蜂窩板材則可提升外牆板的平整度及剛性。

### Coating

Electrostatics powder-coating or Fluorocarbon with Pure white-2112 (RAL9010), Traffic white-2111 (RAL9016) or Standard white-2113 and many colour available.

### 表面處理

象牙白-2112 (RAL9010)、訊號白-2111(RAL9016) 及標準白-2113的靜電粉末或氟碳噴塗及有其他不同的顏色可供選擇。

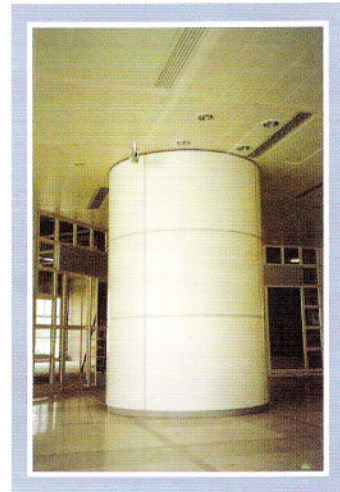

**Concealed Cladding : Panel suspended on pins**  
暗架牆身板：外牆板吊掛於圓柱之上

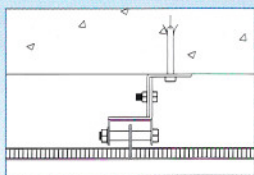

Horizontal Section  
水平切面圖

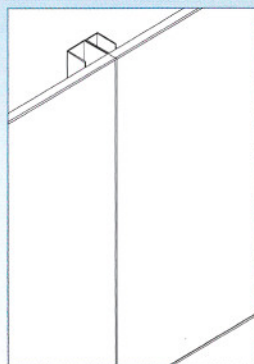

Cladding Installation  
牆身板組裝完成圖

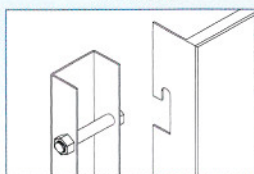

Installation Details  
組裝詳細圖

**Visible Cladding : Panel fixed by bolt & nut**  
明架牆身板：外牆板利用螺絲及絲姆固定

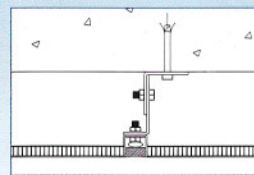

Horizontal Section  
水平切面圖

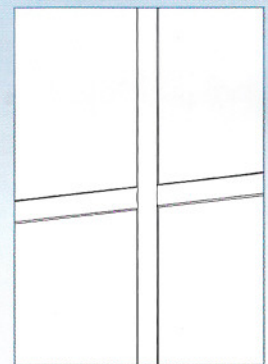

Cladding Installation  
牆身板組裝完成圖

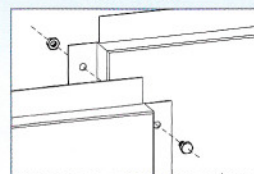

Installation Details  
組裝詳細圖